

High frequency, integral cable accelerometer

712F



Key features

- Corrosion resistant
- Hermetically sealed
- Ground isolated
- ESD protection
- Reverse wiring protection
- EMI/RFI protection

Certifications

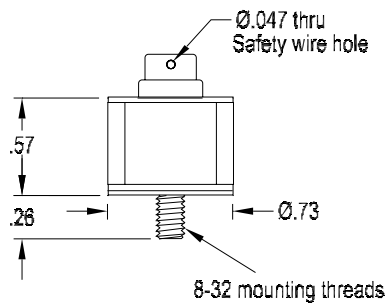
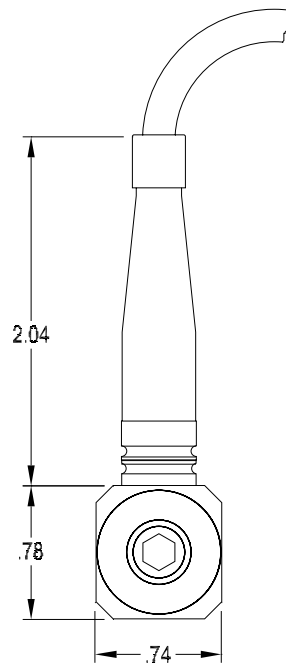

Function	Cable conductor color
power/signal	white
common	black
case	shield

Note: Due to continuous process improvement, specifications are subject to change without notice.
This document is cleared for public release.

Wilcoxon Sensing Technologies
20511 Seneca Meadows Parkway
Germantown, MD 20876
info@wilcoxon.com

Tel: (301) 330 8811
Fax: (301) 330 8873
www.wilcoxon.com

Wilcoxon Sensing Technologies
An Amphenol Company

High frequency, integral cable accelerometer

712F

SPECIFICATIONS

Sensitivity, $\pm 10\%$, 25° C	100 mV/g
Acceleration range	60 g peak
Amplitude nonlinearity	1%
Frequency response:	
$\pm 5\%$	9.0 - 15,000 Hz
$\pm 10\%$	6.0 - 20,000 Hz
± 3 dB	3.0 - 25,000 Hz
Resonance frequency, mounted	>45 kHz
Transverse sensitivity, max	3% of axial
Temperature response:	
-50° C	-10%
+120° C	+10%
Power requirement:	
Voltage source	18 - 30 VDC
Current regulating diode	2 - 10 mA
Electrical noise, equiv g, nominal:	
Broadband 2.5 Hz to 25 kHz	1,000 μ g
Spectral 10 Hz	25 μ g/ \sqrt Hz
100 Hz	10 μ g/ \sqrt Hz
1000 Hz	8 μ g/ \sqrt Hz
Output impedance, max	100 Ω
Bias output voltage, nominal	12 VDC
Grounding	case isolated, internally shielded
Temperature range:	-50 to +120° C
Vibration limit	$\pm 1,000$ g
Shock limit, max	5,000 g peak
Sealing	hermetic
Base strain sensitivity, max	0.03 g/ μ strain
Sensing element design	PZT ceramic / shear
Weight	35 grams
Case material	316L stainless steel
Mounting	8-32 captive screw with 0.047" diameter safety wire hole
Mating connector	N/A
Integral cabling	J9T2A, 16 ft. blunt cut

Contact

Wilcoxon Sensing Technologies

20511 Seneca Meadows Parkway
Germantown MD 20876, USA

Tel: +1 301 330 8811
Fax: +1 301 330 8873

info@wilcoxon.com

www.wilcoxon.com

Accessories supplied:

- Calibration data (level 2)
- 8-32 captive screw

Note: Due to continuous process improvement, specifications are subject to change without notice.
This document is cleared for public release.

Wilcoxon Sensing Technologies
20511 Seneca Meadows Parkway
Germantown, MD 20876
info@wilcoxon.com

Tel: (301) 330 8811
Fax: (301) 330 8873
www.wilcoxon.com

Wilcoxon Sensing Technologies
An Amphenol Company