



## Conductive Level Switch Compact Probe



measuring  
•  
monitoring  
•  
analysing

### LNK-K



(When using  
LZE-hygienic  
installation system)



Weld-in sleeve LZE

- $p_{\max}$ : 10 bar;  $t_{\max}$ : 100 °C  
150 °C for CIP process
- Electrode,  
any lengths up to 1500 mm
- Process connections: G 1/2  
installation meets hygiene  
standards through  
EHEDG-certified  
installation system LZE
- Materials approved for  
handling of foodstuffs
- Optional evaluating  
electronics integrated
- Optional:  
E-CTFE coating



KOBOLD companies worldwide:

ARGENTINA, AUSTRALIA, AUSTRIA, BELGIUM, BULGARIA, CANADA, CHILE, CHINA, COLOMBIA, CZECHIA, EGYPT, FRANCE, GERMANY, GREAT BRITAIN, HUNGARY, INDIA, INDONESIA, ITALY, MALAYSIA, MEXICO, NETHERLANDS, PERU, POLAND, REPUBLIC OF KOREA, ROMANIA, SINGAPORE, SPAIN, SWITZERLAND, TAIWAN, THAILAND, TUNISIA, TURKEY, USA, VIETNAM

KOBOLD Messring GmbH  
Nordring 22-24  
D-65719 Hofheim/Ts.  
Head Office:  
+49(0)6192 299-0  
+49(0)6192 23398  
info.de@kobold.com  
www.kobold.com

**Description**

The conductive KOBOLD level probes LNK-K are used for level measurement. The electrical resistance between the metallic vessel and level electrode is measured and evaluated.

In combination with the KOBOLD LZE or LZE-R weld-in sleeves, the probe provides a measuring point that has no dead space and meets hygiene standards and (EHEDG approval certificate). This level switch is therefore very well suited for CIP/SIP cleaning and because of its compact design the device is suitable for almost every measurement.

The KOBOLD probes LNK-K are also available with integrated evaluating electronics. The output signal (24 V<sub>DC</sub>) can thus be connected to a PLC for evaluation. This means lower installation costs, minimum wiring requirements and a high degree of noise immunity.

The level probes are connected electronically through an M12x1 plug connection. Different stem lengths are available. The stem may also be E-CTFE coated, so that foaming media can be detected.

**Applications**

- Level monitoring in all conductive media

**Technical Details**

Measuring principle: conductive  
 Process temperature: -20 ... +100 °C, 150 °C for CIP-process  
 Ambient temperature: 0 ... 70 °C  
 Operating pressure: max. 10 bar

**Material**

- Head, thread supports: stainless steel 1.4404
- Insulating section: PEEK
- Electrode stem: stainless steel 1.4404
- Stem coating: E-CTFE, coating 0,3 mm
- Electrode length: 100, 250, 500, 750, 1000, 1500 mm
- Process connection: G 1/2, hygienic weld-in sleeves LZE or LZE-R
- Connection: M12x1-Stecker

**Technical Details (continued)**

Protection: IP 67  
 Weight: approx. 0.6 kg  
**Switch electronics**  
 Power supply: 15 ... 36 V<sub>DC</sub>, 15 mA  
 Electrode voltage: 2 V<sub>AC</sub> / 500 Hz  
 Sensitivity (adjustable): 3 steps 2/20/200 kΩ  
 Function: Full /empty report (determined via the polarity of the supply voltage)  
 Output: PNP, open collector, U<sub>off</sub> = +V<sub>vers.</sub> - 1.0 V max. 50 mA, short-circuit-proof  
 Switch delay: 1 s

**Dimensions**

with switch electronics

without switch electronics

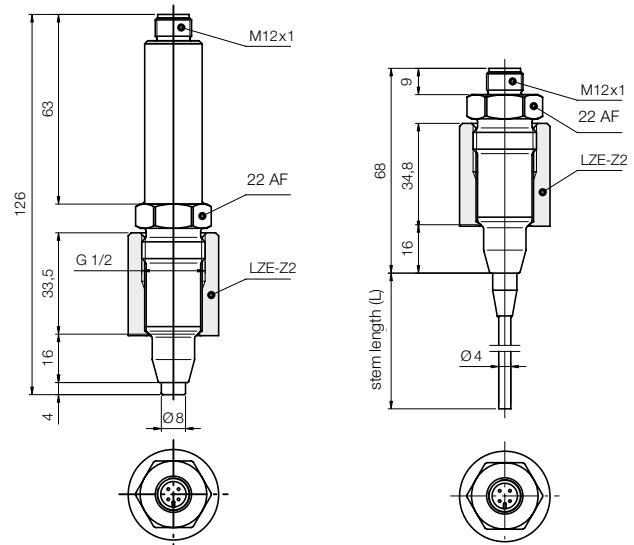

EHEDG certification of the connection system in combination with built-in sleeve LZE.

**Order Details (Example: LNK-K 2 0 A 00S)**

Model	Design	Electrode material	Electrode coating	Electrode length	Evaluation/ Electrical connection
LNK-	K = compact version	2 = st. steel 1.4404	0 = without coating E = E-CTFE-coating	A = 4 mm stump B = 100 mm C = 250 mm D = 500 mm E = 750 mm F = 1000 mm G = 1500 mm	00S = without electronics, M12x1 plug, 4 pole  NPS = switch electronics, PNP-switch output, M12x1 plug, 4 pole

External switch electronic: Electrode relay NE 104 and NE 304.