

Low profile industrial accelerometer 787AM8

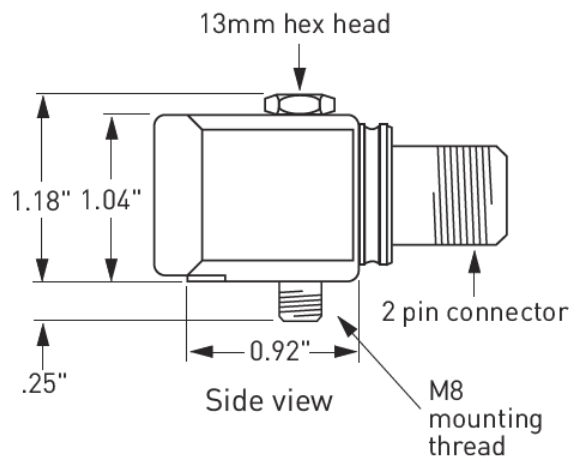

Key features

- Corrosion resistant
- Hermetically sealed
- Ground isolated
- ESD protection
- Reverse wiring protection
- Ideal for moderate industrial environments, conveyors and drives

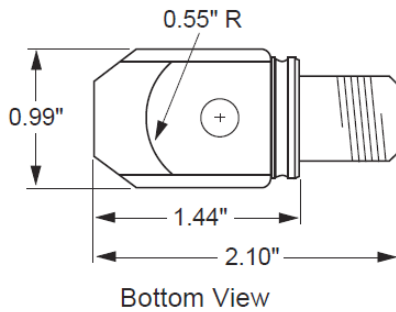

Connections		
Function	Connector pin	Cable conductor color
power / signal	A	white
common	B	black
ground	shell	shield

Note: Due to continuous process improvement, specifications are subject to change without notice.
This document is cleared for public release.

Wilcoxon Sensing Technologies
20511 Seneca Meadows Parkway
Germantown, MD 20876
info@wilcoxon.com

Tel: (301) 330 8811
Fax: (301) 330 8873
www.wilcoxon.com

Wilcoxon Sensing Technologies
An Amphenol Company

Low profile industrial accelerometer

787AM8

SPECIFICATIONS

Sensitivity, $\pm 5\%$, 25° C	100 mV/g
Acceleration range¹	80 g peak
Amplitude nonlinearity	1%
Frequency response:	$\pm 10\%$ 1.0 - 5,000 Hz ± 3 dB 0.7 - 10,000 Hz
Resonance frequency, mounted, min	22 kHz
Transverse sensitivity, max	5% of axial
Temperature response:	-25° C -10% +120° C +10%
Voltage source¹	18 - 30 VDC
Current regulating diode^{1,2}	2 - 10 mA
Electrical noise, equiv g, nominal:	
Broadband 2.5 Hz to 25 kHz	700 μ g
Spectral 10 Hz	10 μ g/ \sqrt Hz
100 Hz	5 μ g/ \sqrt Hz
1000 Hz	5 μ g/ \sqrt Hz
Output impedance, max	100 Ω
Bias output voltage, nominal	12 VDC
Grounding	case isolated, internally shielded
Temperature range	-50 to +120° C
Vibration limit	500 g
Shock limit, min	5,000 g
Electromagnetic sensitivity, equiv g, max	70 μ g/gauss
Sealing	hermetic
Base strain sensitivity, max	0.002 g/ μ strain
Weight	145 grams
Case material	316L stainless steel
Mounting	M8 captive hex head screw with 0.046" diameter safety wire hole
Output connector	2 pin, MIL-C-5015 style
Mating connector	R6 type
Recommended cabling	J9T2A, two conductor shielded, Teflon [®] jacketed

Contact

Wilcoxon Sensing Technologies

20511 Seneca Meadows Parkway
Germantown, MD 20876, USA

Tel: +1 301 330 8811
Fax: +1 301 330 8873

info@wilcoxon.com

www.wilcoxon.com

Accessories supplied:

- SCM8125 captive hex head screw
- Calibration data

Notes: ¹ To minimize the possibility of signal distortion when driving long cables or high vibration signals, 24 to 30 VDC powering is recommended. The higher level constant current source should be used when driving long cables (please consult customer service).

² A maximum current of 6 mA is recommended for operating temperatures in excess of 100°C.

Note: Due to continuous process improvement, specifications are subject to change without notice.
This document is cleared for public release.

Wilcoxon Sensing Technologies
20511 Seneca Meadows Parkway
Germantown, MD 20876
info@wilcoxon.com

Tel: (301) 330 8811
Fax: (301) 330 8873
www.wilcoxon.com

Wilcoxon Sensing Technologies
An Amphenol Company