

Electronic Pressure Switch



measuring
•
monitoring
•
analyzing

PDL



- Switching Range: 0.1...1 to 60...600 bar
- Max. Temperature: 80 °C
- Connection: 1/4" NPT or G 1/4
- Material: Brass
- Repeatability: $\leq 1\%$ of Full Scale



KOBOLD companies worldwide:

ARGENTINA, AUSTRIA, BELGIUM, BULGARIA, CANADA, CHILE, CHINA, COLOMBIA, CZECH REPUBLIC, EGYPT, FRANCE, GERMANY, GREAT BRITAIN, HUNGARY, INDIA, INDONESIA, ITALY, MALAYSIA, MEXICO, NETHERLANDS, PERU, POLAND, ROMANIA, SINGAPORE, SOUTH KOREA, SPAIN, SWITZERLAND, TAIWAN, THAILAND, TUNISIA, TURKEY, USA, VIETNAM

KOBOLD Instruments, Inc.
1801 Parkway View Drive
Pittsburgh, PA 15205
☎ Main Office:
1.800.998.1020
☎ 1.412.788.4890
info@koboldusa.com
www.koboldusa.com



Description

The KOBOLD PDL Series electronic pressure switch is an economical pressure monitor with a switch output that can be easily adjusted on-site by turning an adjustment screw. With the help of a spring-assisted measuring element and the use of a Hall-Effect sensor, the PDL Series electronic pressure switch can provide a maximum of two switching outputs for a given pressure. One or two switching outputs can be delivered as a normally open or normally closed (N/O or N/C) configuration. The compact size, rugged construction and wide adjustable pressure range make it an ideal pressure switch for OEM usage.

Specifications

Housing

PDL-0: Brass
PDL-1: Anodized Aluminum

Upper Housing: Plastic

Process Connection: Brass, 1/4" NPT, G 1/4

Measuring Element

PDL-0: Copper Alloy, Capsule Element
PDL-1: 316L Stainless Steel, Spiral Spring

Maximum Temperature

Storage: -30...80 °C
Media: -20...80 °C
Ambient: -20...80 °C

Temp. Comp. Range: 0...80 °C

Temperature Influence: 0.4% / 10 K

Overload Limit

≤ 10 bar: 4x Range
≥ 16 bar: 2x Range

Load Change: 1 x 10⁶

Dimensions (mm)

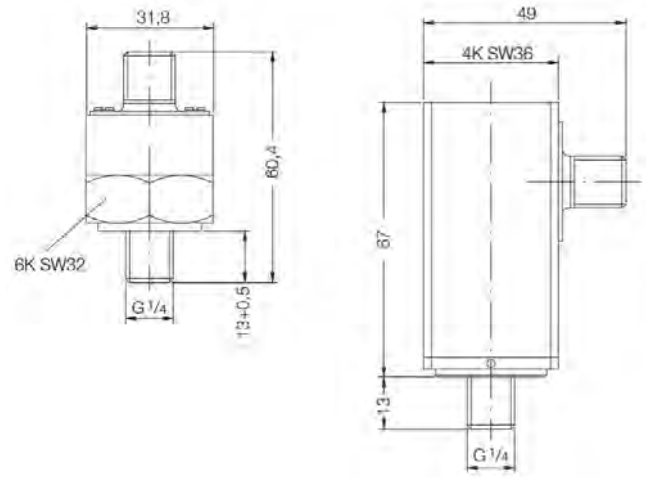

Electrical Connection: M12 x 1 Plug (4-pole)
 (Option: 1.5 m Cable)

Switching Function: N/C or N/O, p-switching

Range Adjustment: 10...100% of Full Scale

Switchpoint Adjustment: Via Adjustment Screw

Repeatability: < 1% of Full Scale

Switching Hysteresis: ≤ 5% of Full Scale
 ≤ 10% of Full Scale at 16 and 25 bar

Power Supply: 10...30 VDC

Power Rating: Max. 100 mA (Max. 30 VDC)

Protection: IP 65 (IP 67 with Cable Output)

Order Details (Example: PDL-0131 N2 B025)

Model	Description	Output	Connection	Switching Range (on Increasing Pressure)
PDL-01..	Electronic Pressure Switch Brass Housing M12 x 1 Plug	..31.. = 1 N/O Contact ..32.. = 2 N/O Contacts ..33.. = 1 N/C Contact ..34.. = 2 N/C Contacts ..35.. = 1 N/O & 1 N/C	..N2.. = 1/4" NPT ..R2.. = G 1/4 Male	..C315 = -0.9...-0.05 Bar ..B126 = 0.005...0.1 Bar ..B025 = 0.05...1.0 Bar ..B045 = 0.013...2.5 Bar ..B055 = 0.2...4.0 Bar ..B065 = 0.3...6.0 Bar ..B075 = 0.5...10 Bar ..A095 = 2.5...25 Bar
PDL-11..	Electronic Pressure Switch Aluminum Housing M12 x 1 Plug	..31.. = 1 N/O Contact ..32.. = 2 N/O Contacts ..33.. = 1 N/C Contact ..34.. = 2 N/C Contacts ..35.. = 1 N/O & 1 N/C	..N2.. = 1/4" NPT ..R2.. = G 1/4 Male	..A115 = 3.0...60 Bar ..A125 = 5...100 Bar ..A135 = 8...160 Bar ..A145 = 13...250 Bar ..A155 = 20...400 Bar ..A165 = 30...600 Bar